



SAULT  
COLLEGE



# Sault College Main Campus

## Fire Alarm – Basic Training

10 April, 2024



# Overview

---

The safety and the welfare of all our employees, students and visitors is number one priority at Sault College.

We have a responsibility for protecting life and property from the effects of fire and other emergencies.

Please follow this training module to gain an understanding of the basic requirements of our fire alarm system.



# System of Devices

Our campus is equipped with a fire alarm system consisting of:

- Pull stations
- Smoke and heat detectors
- Speaker Strobes

You will see these devices mounted on the walls and ceilings throughout campus.

When activated, you will hear messages broadcasted throughout the school



# When the FIRE ALARM Sounds...

---

- Remain calm
- Listen to the instructions for next steps
- Do not assume that it is a false alarm
- Do not use the elevators
- Do not to interfere with the Fire Department.



# How the fire alarm system works

It is one system that functions differently in each wing. Each wing is setup with two stages: **emergency** or **alert**.

When the fire alarm is active it will:

1. Automatically close the doors in hallways between wings throughout the entire school,
2. Initiate a state of **emergency** in the wing with an active device,
3. Initiate a state of **alert** in all other wings.

The system is setup this way to avoid disrupting activities and evacuating the whole school prematurely



Note the system on campus is different than residence. Refer to their procedures if applicable.

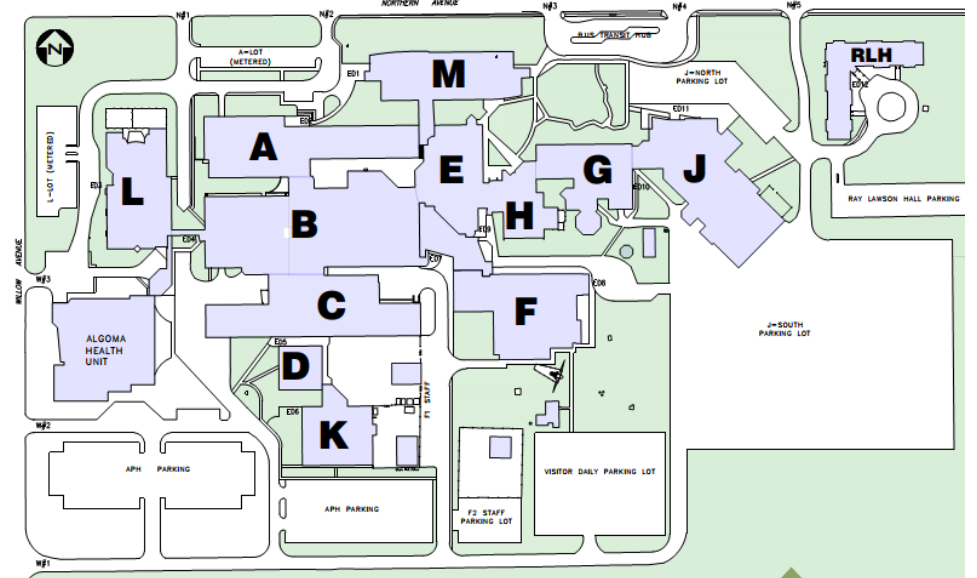

CAMPUS MAP

# Evacuation Stage

What Should You Do When you hear the message:

“THIS IS A **FIRE ALARM**, PLEASE EVACUATE THE BUILDING IMMEDIATELY”

- Immediately and orderly, evacuate the building via the nearest exit door to a safe area away from the building.
- Do not wander throughout the building.

Watch the video!

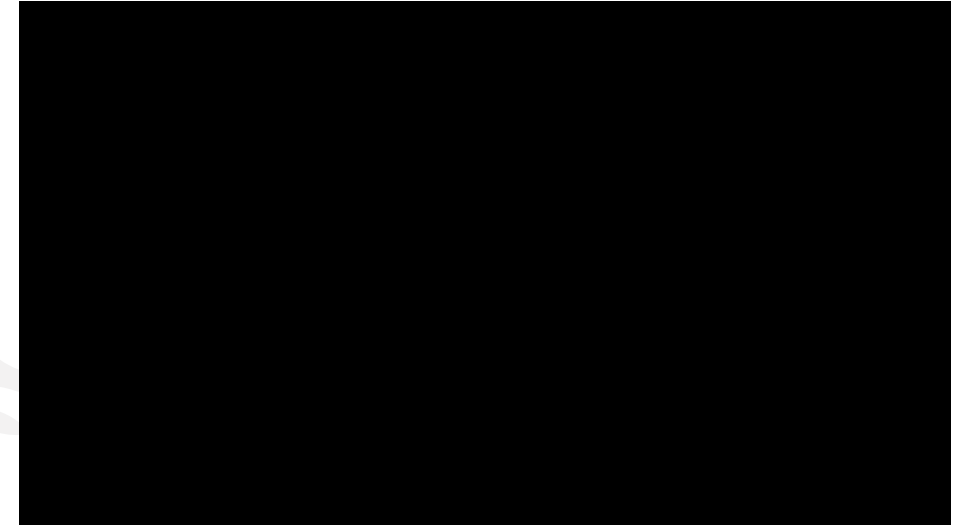

# Alert Stage

What Should You Do When you hear the message:

“THIS IS ONLY AN ALERT, PLEASE WAIT FOR FURTHER INSTRUCTIONS”

- Remain where you are. Do not wander throughout the building.
- Carry on normal activities
- Listen for a different message
- Be prepared to vacate the building

Watch the video!



# Scenario Example:

Bwing is in emergency evacuation. All occupants are to evacuate the building immediately!

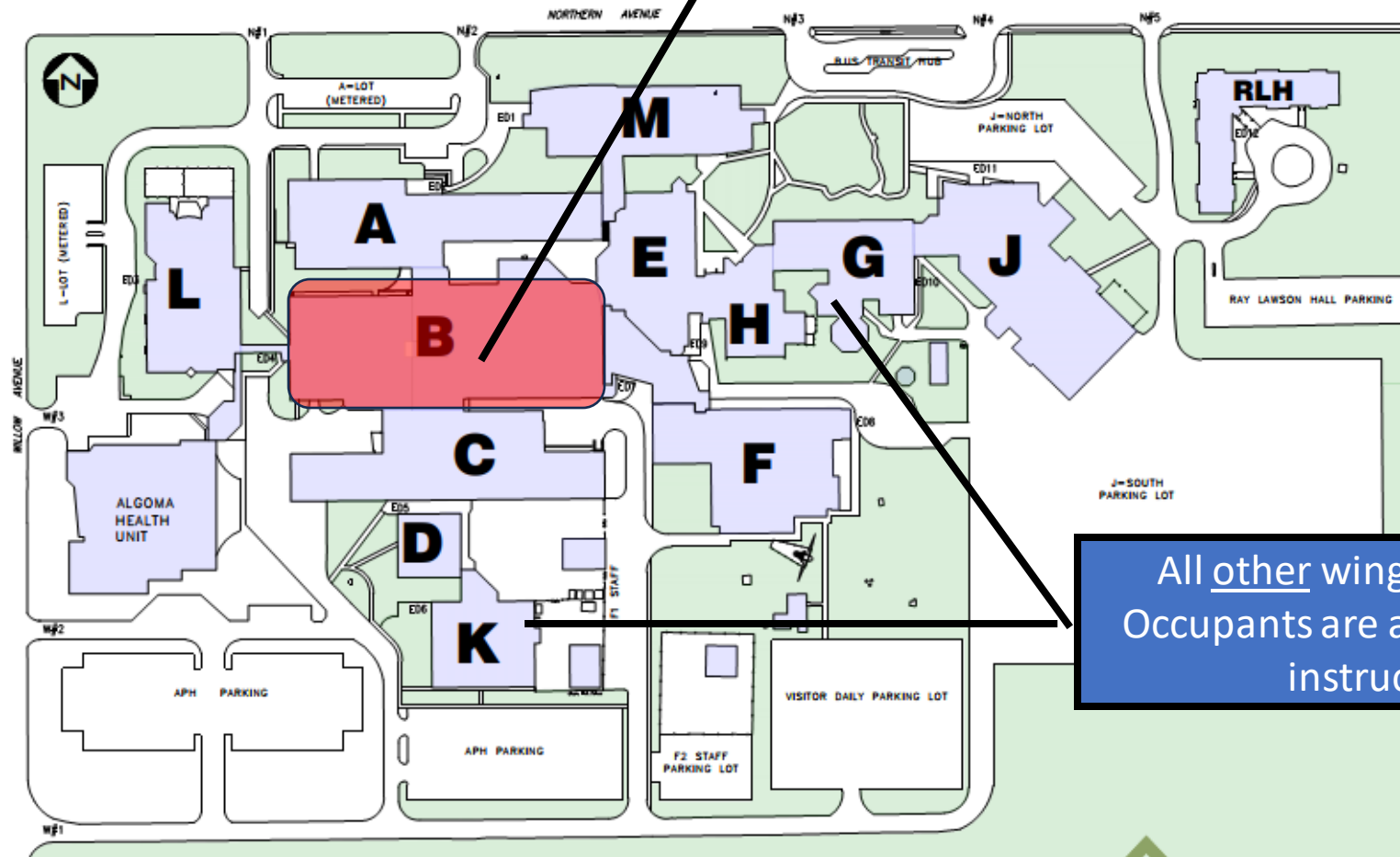

All other wings are in alert. Occupants are awaiting further instructions.

CAMPUS MAP



## Emergency Ends

---

- **DO NOT** re-enter the building until informed by authorized security who are acting under the direction of Authorized College Staff and the Fire Captain at the scene.



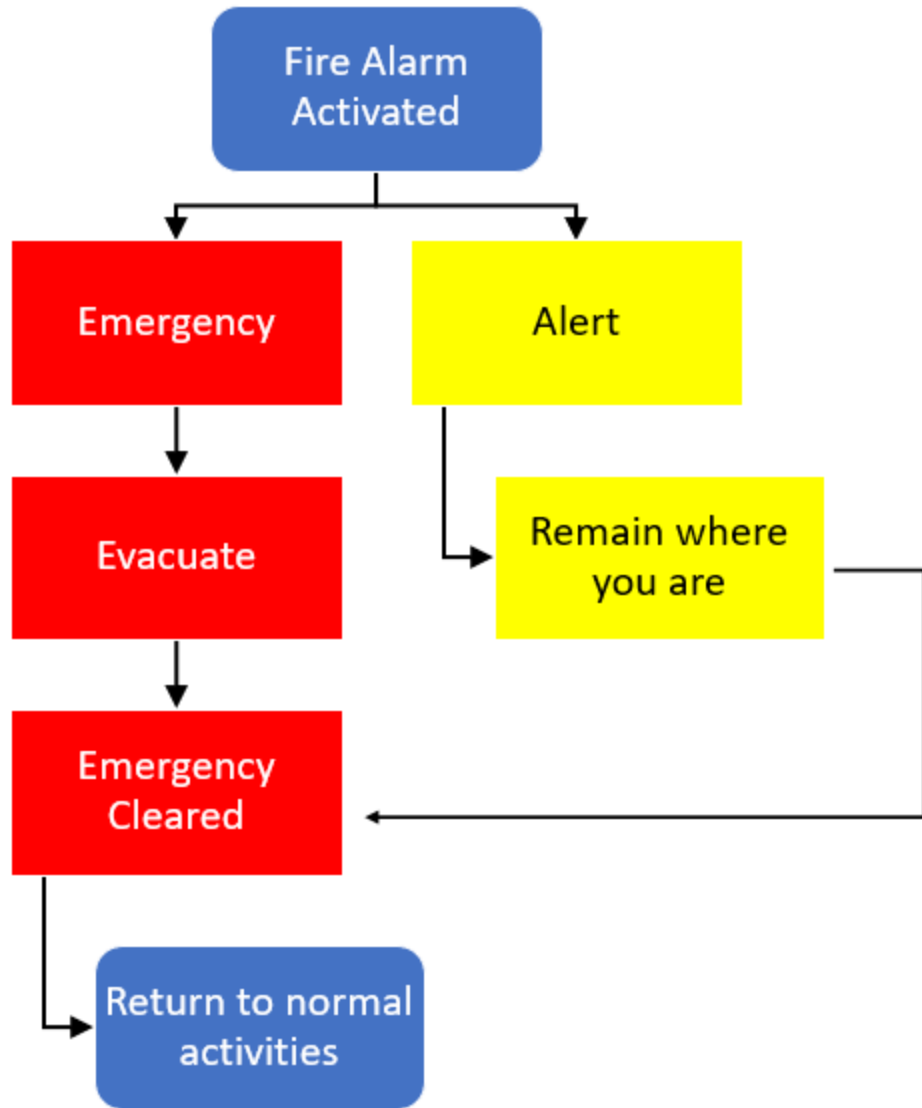

## Activity Summary

